

NOTE:
 Precinct 3 will start at the intersection of North Lake Drive and South Lake Drive on the east side of Lake Kampeska and will take in any additions south of the lake within the city limits and will continue west and north to North Lake Drive. Precinct 4 will start at the intersection of North Lake Drive and South Lake Drive on the east side of Lake Kampeska and will take in any additions north of the lake within the city limits and will continue west and south to South Lake Drive.

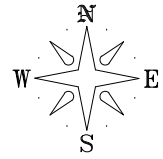
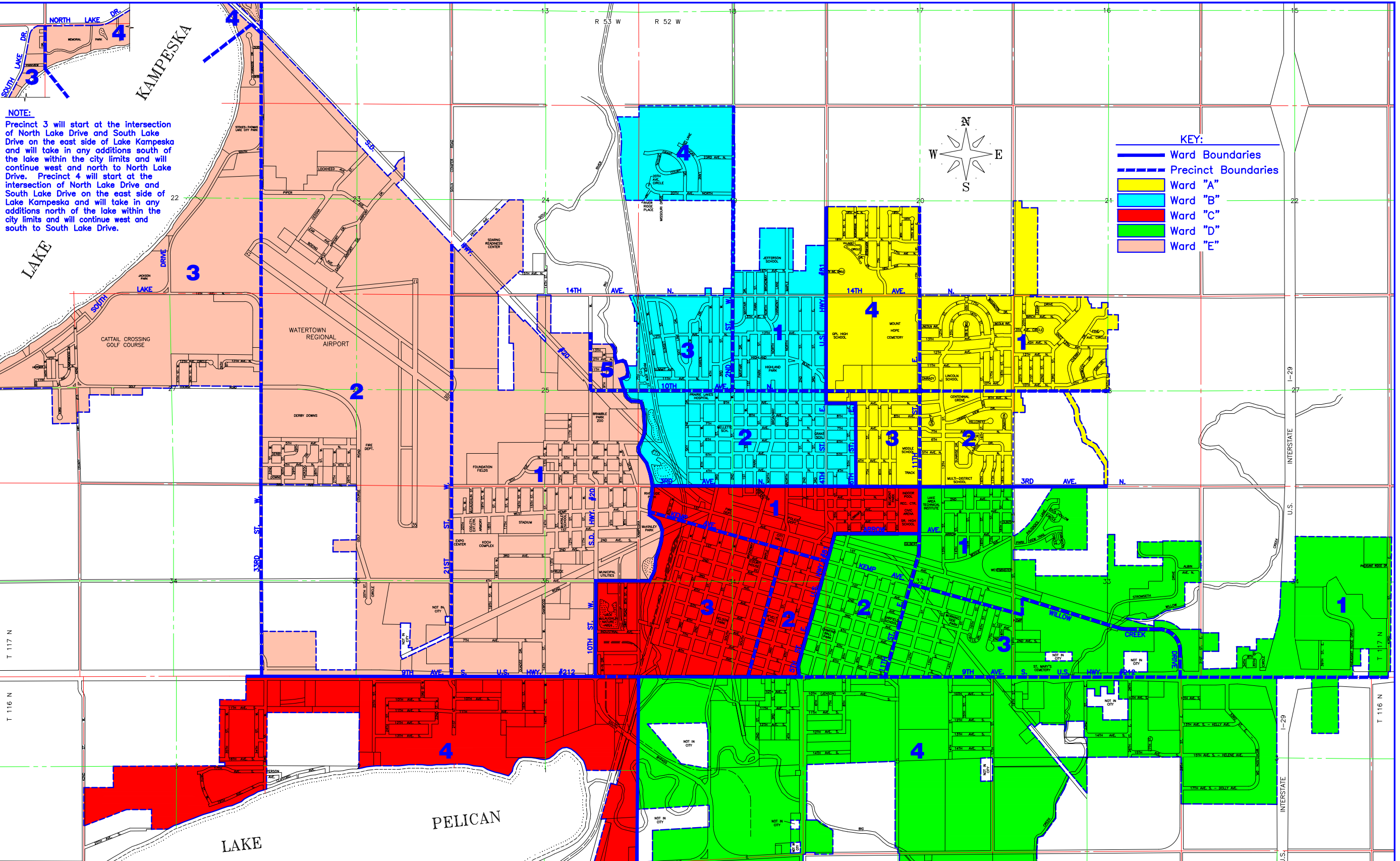

- KEY:**
- Ward Boundaries
 - Precinct Boundaries
 - Ward "A"
 - Ward "B"
 - Ward "C"
 - Ward "D"
 - Ward "E"

County Commissioner District - Township/Precinct Assignments				
District I	District II	District III	District IV	District V
Ward B: All Ward C: 1 Ward E: 5	Ward C: 3 & 4	Ward E: 1-4	Ward A: All Ward D: 1	Ward C: 2 Ward D: 2-4
No Townships	Eden Twp, Phipps Twp Wallace V, Fuller Twp Florence V Graceland Twp Henry Twp & V Kampeska Twp Pelican Twp Richland Twp	Dexter Twp Germantown Twp Lake Twp Rauville Twp	No Townships	Elmira Twp Kranzburg Twp & V Leola Twp South Shore V Sheridan Twp Waverly Twp

**2011 WARDS
&
PRECINCTS MAP
WATERTOWN, SD**

Office of the City Engineer
 Eng.: Tom Drake
 Dwn. By: RES 3-2-2012
 Not to Scale